

1 Queen Caroline Street

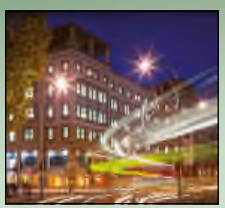
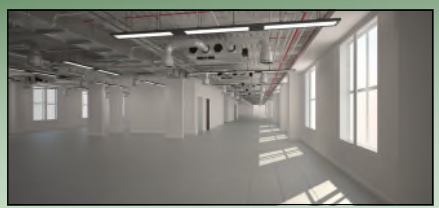

Project:
1 Queen Caroline Street

Location:
Hammersmith

M&E Contractor:
DBS

Completion:
July 2015

The project created 7,758 square meters of prime office space complete with a basement car park, right on top of Hammersmith Tube Station.

Rather than being hidden in ceiling voids, all of the services are fixed directly to an exposed slab, calling for high level craftsmanship to give a quality finish.

iBMS installed a *TREND* Building Management System to control the heating, hot water and ventilation systems. Over 230 4-pipe Fan Coil Units have IQeco31 controllers complete with Pressure Independent Control Valves. The Supervisor PC runs 963 software which is remotely monitored via the internet.