

Unilever Headquarters Leatherhead

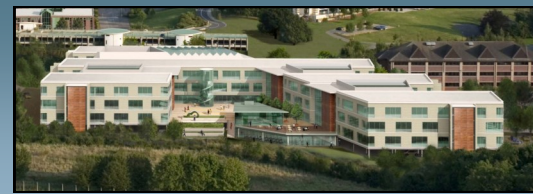

Project:
Unilever
Headquarters

Location:
Leatherhead

M&E Contractor:
Derry
Building Services

Completion:
May 2008



TREND automatic controls for 19,000m² of high quality office space over 3 floors, with basement parking for 520 cars.

Part of the development includes a separate building to house a cafe, staff gym and health centre, for incoming tenant Unilever.

The air conditioning is served by Ground Source Heat Pumps, connected to dozens of boreholes, and the BMS sequences the units in heating and cooling modes to suit the requirements of the building.

Control Systems installed in each wing, the Energy Centre and several hundred Fan Coil Units are networked by Ethernet, over fibre optic, to a 963 Supervisor PC, providing the building operator with comprehensive energy monitoring and environmental controls.